

BI 02

BASILDON DISTRICT COUNCIL

THE DISTRICT OF BASILDON (VARIOUS ROADS, BASILDON DISTRICT) (PERMITTED PARKING AREA AND SPECIAL PARKING AREA) (WAITING RESTRICTIONS, STREET PARKING PLACES AND OFF STREET PARKING PLACES) CONSOLIDATION (AMENDMENT NO.1) ORDER 2003

The Basildon District Council, pursuant to arrangements made under Section 19 of the Local Government Act 2000 with Essex County Council, in exercise of the powers conferred on that said County Council under Sections 1(1), 2(1) to (3), 4(2), 32(1), 35(1), 45, 46, 46A, 49 and 53 of the Road Traffic Regulation Act 1984 (hereinafter referred to as "the Act"), as amended, and of all other enabling powers and after consultation with the Chief Officer of Police in accordance with Part III of Schedule 9 of the Act, hereby makes the following Order:-

1. This Order will come into operation on 1 September 2003 and may be cited as "The District of Basildon (Various Roads, Basildon District) (Permitted Parking Area and Special Parking Area) (Waiting Restrictions, Street Parking Places and Off Street Parking Places) Consolidation (Amendment No.1) Order 2003.
2. The provisions of the District of Basildon (Various Roads, Basildon District) (Permitted Parking Area and Special Parking Areas) (Waiting Restrictions, Street Parking Places and Off Street Parking Places) Consolidation Order 2003 plan numbers G37, G38, G39, H37, H38, H39, H40, I37, I38, I39 and I40 are hereby amended by plans HI2769.001, HI2739.002B and HI2737.002B attached hereto.

Dated this 19th day of August 2003

THE COMMON SEAL of the)
DISTRICT COUNCIL of)
BASILDON was hereunto)
affixed by Order:)

dsone

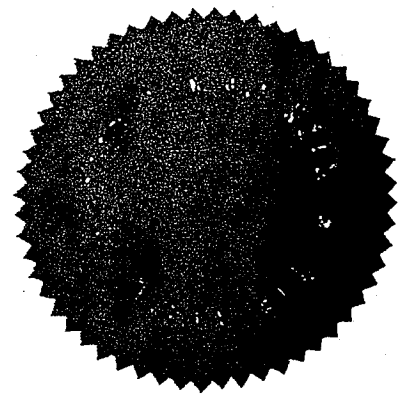

Acting Solicitor to the Council

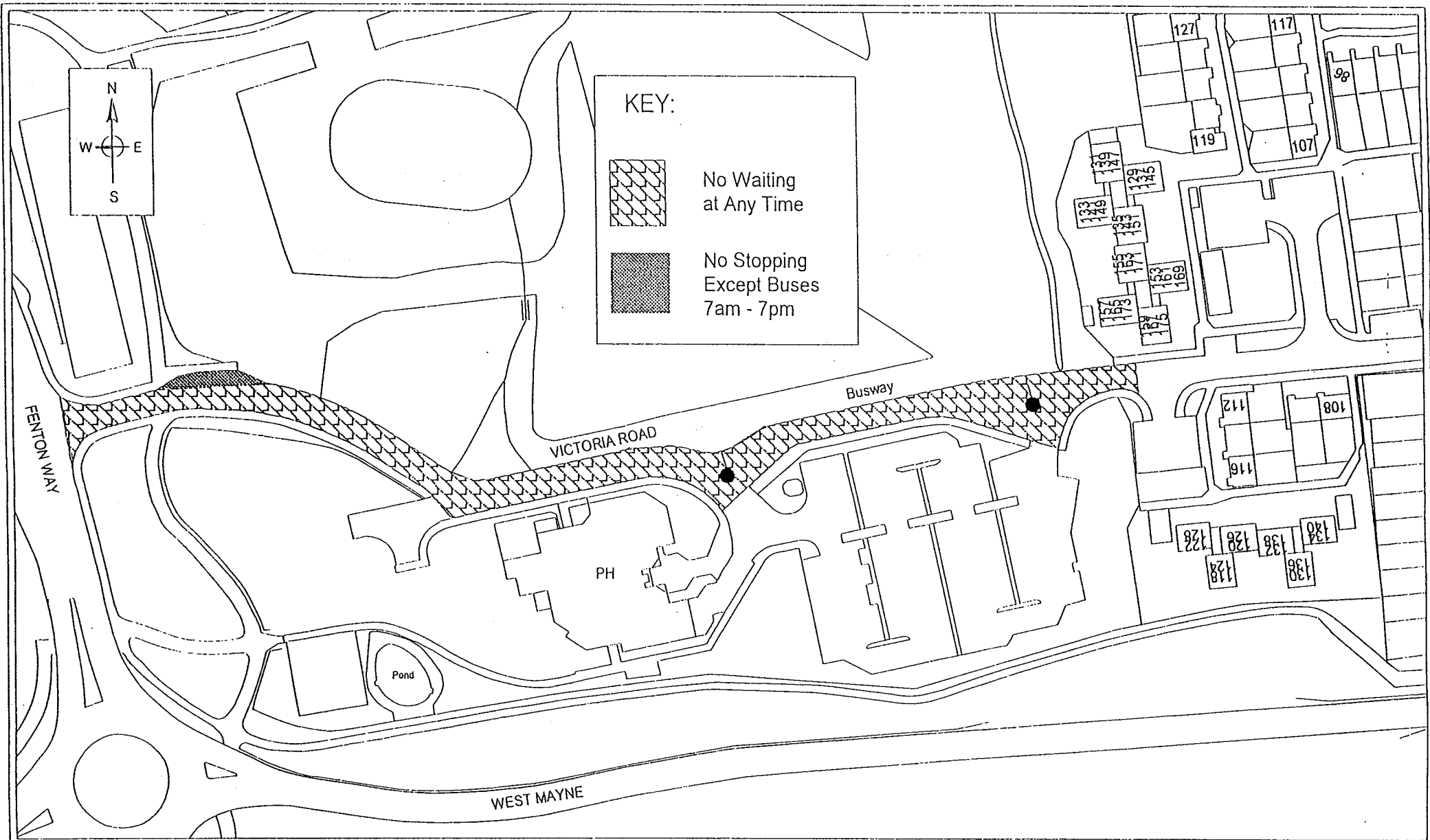

Based upon the Ordnance Survey mapping with the permission of the Controller of Her Majesty's Stationery Office © Crown Copyright. Unauthorised reproduction infringes Crown Copyright and may lead to prosecution or civil proceedings. Basildon District Council - LA 077070 1997

BASILDON DISTRICT COUNCIL
CIVIL ENGINEERING SERVICES

Eur. Ing. R.G. Wilhers C.Eng. FICE., FIHT
Manager of Highways & Engineering Services
The Basildon Centre, St. Martins Square,
Basildon, Essex SS14 1DL. Tel: 01268 533333

JOB
Proposed Traffic
Regulation Order

DRAWING
Victoria Road,
Laindon

Drawn P.T.H.	Traced =	Checked RKW	Verified RKW	Issue Auth. RW	Date July02
Scale 1:1250	REF. No. HI 2769.001				



KEY:

EXISTING WAITING RESTRICTIONS	PROPOSED PROHIBITION OF WAITING AND WAITING RESTRICTIONS
Waiting Restriction 3am-6pm Mon-Sat	Residential Permit Parking 10am - 2pm Mon - Fri
Parking Permitted for 1 hour, NO 2nd hour within 4 hours 3am - 6pm Mon - Sat	Waiting Restriction 3am - 6pm Mon - Sat
No Waiting at Any Time	Waiting Restriction 10am - 2pm Mon - Fri
	No Waiting at Any Time
	Change to No Waiting 3am - 6pm Mon - Sat

3	Waiting restrictions in Somerset Road, Suffolk Drive and Fendale Close removed	P.T.H.	Aug 03
4	Residential parking bays added in Somerset Road, Sedford Road and Bomsdown Avenue with restriction lines extended. Waiting restriction in Aston Road changed to 3am-6pm Boxes added showing areas covered by other plans.	P.T.H.	R.K.W. Dec 02
Amend Ref	Amendments	Amend By	Ver Date

Based upon the Ordnance Survey mapping with permission of the Controller of Her Majesty's Stationary Office © Crown Copyright. Unauthorised reproduction infringes Crown Copyright and may lead to prosecution or civil proceedings. Basildon District Council - LA 077079 1997





BASILDON DISTRICT COUNCIL
CIVIL ENGINEERING SERVICES

Eur. Ing. R.G.Wilbers C.Eng, FICE., FIHT
Manager of Highways & Engineering Services
The Basildon Centre,
St. Martins Square, Basildon,
Essex SS14 1DL
Tel: 01268 533333

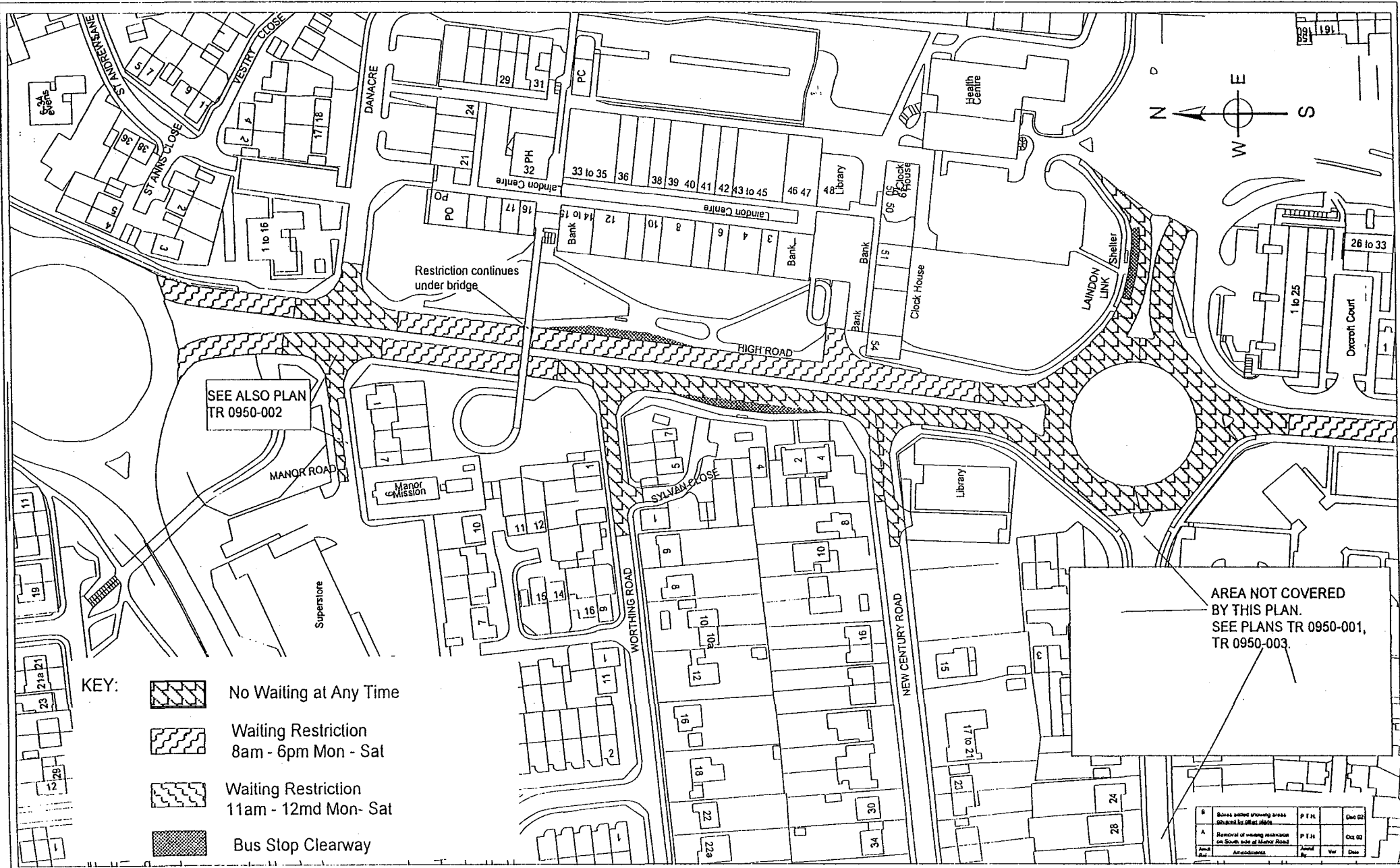
TITLE
Proposed Traffic Regulation
Order High Road, Bedford
Road, Laindon and surrounding
roads

SCALES	1:1250	Date	Sept 02		
Drawn	P.T.H.	Traced	Checked	Verified	Issue AUTH.
REF. No.	HI 2739-002B				



- KEY:**
-  No Waiting at Any Time
 -  Waiting Restriction 8am - 6pm Mon - Sat
 -  Waiting Restriction 11am - 12md Mon - Sat
 -  Bus Stop Clearway

Based upon the Ordnance Survey mapping with permission of the Controller of Her Majesty's Stationery Office © Crown Copyright. Unauthorised reproduction infringes Crown Copyright and may lead to prosecution or civil proceedings. Basildon District Council - LA 077070 1997

BASILDON DISTRICT COUNCIL
CIVIL ENGINEERING SERVICES

The Basildon Centre,
Page Mead, Basildon,
Essex SS14 1DL
Tel: 01268 533333

JOB
Proposed Prohibition and
Restriction of Waiting

DRAWING
High Road, Laindon
and surrounding area

Drawn P.T.H.	Traced =	Checked RKW	Verified RKW	Issue Auth. RGW	Date July 02
Scale 1:1250	REF. No. HI 2737-002B				

B	Boxes added showing areas proposed for other plans	P.F.H.	Dec 02
A	Removal of waiting restrictions on South side of Manor Road	P.F.H.	Oct 02
Amend	Amendments	Amend By	Ver Date